

# Rosicrucian Digest®

Volume 80 • Number 3 • 2002

## *The Future of Rosicrucian Park*

*Part Two of a  
Two-Part Series*

MYSTICISM

•

ART

•

SCIENCE





(above) *The Grand Temple at dusk.*



*Two views of the Grand Temple's Portal (outer doorway).*



(above) *The Grand Temple's Lodge Room and (right) one of the Temple's murals depicting Pharaoh Akhnaton in his chariot under the rays of the Aton.*



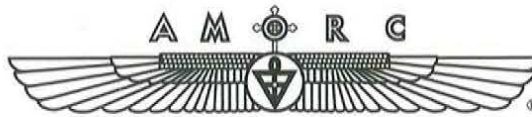

Bureau de l'Imperator  
Château d'Omonville  
27110 Le Tremblay  
France

*Ordo Rosae Crucis*

Office of the Imperator in France  
Château d'Omonville  
27110 Le Tremblay  
France

*Under the Auspices of the Rose-Croix,  
Salutem Punctis Trianguli!*

Dear fratres, dear sorores,

My first visit to Rosicrucian Park dates back to 1966 when I was 14 years old. It was on the occasion of a Rosicrucian Convention. Some members from the French language jurisdiction had taken this opportunity to travel and I had the good fortune to accompany them as a Torchbearer.

In my youthful mind, it was not only Rosicrucian Park or California that I would discover, but America! The adventure and wonder lived up to my expectations. Immediately I became attached to this country and especially to Rosicrucian Park which seemed to me to be very mysterious, as all the Egyptian décor made a great impression on me. At that time I was not familiar with Egypt, but only with France and a few neighboring countries.

I will never forget this first visit to San Jose, especially since on my return home I decided to become a Rosicrucian. Not having yet reached the age to join the Order, I petitioned our Imperator, Frater Ralph Lewis, who agreed that I could cross the Threshold of our Order on the day I became 15 years old. Therefore, I can say that my first visit to Rosicrucian Park marked the beginning of my Rosicrucian life. The following year, I had the greatest honor of being invited for a long stay in the home of Frater and Soror Lewis. Then, on several occasions, I had the opportunity to return to Rosicrucian Park for Conventions, both as a frater and as the Grand Master of the French language jurisdiction.

When "destiny" called me to the office of Imperator, I was drawn to this historical place on numerous occasions, and often for some rather lengthy stays. It was in the Supreme Temple that my installation ceremony took place, surrounded by my wife and children, as well as some friends from France, and certainly by many fratres and sorores from San Jose. I look upon these and other such occasions in San Jose as most touching memories.

For some years now, I have returned to the Park regularly, at least once a year, and it is always with much happiness that I stroll through the gardens and greet fratres and sorores who have always remained faithful to this place. Here I have known many friends and I have also lost many, since the time has come for them to complete their incarnation. Nonetheless, they are always in my heart, and whenever I am at Rosicrucian Park, I think of them once again.

Sincerely and fraternally,

*Christian Bernard* 

Christian Bernard  
IMPERATOR



Dear Fratres and Sorores,

The years 2002-2003 mark the 75th anniversary of Rosicrucian Park. The previous issue of the *Rosicrucian Digest* featured some of the many important events in the history of Rosicrucian Park. This issue of the Digest focuses on the current state of Rosicrucian Park and its future.

Throughout Rosicrucian Park's history, the buildings have been replaced, modified, and used for various purposes. The original outdoor shrine was replaced by the more permanent Akhnaton Shrine. The current Rosicrucian Egyptian Museum, built in 1966, replaced the smaller Oriental Museum as the collection had outgrown the earlier structure. The former administration building was replaced with the current administration building in 1970.

Change has been a constant at Rosicrucian Park, as predicted by Dr. Lewis in 1934 when he wrote, "Of course, we cannot tell how long the present buildings will stand on their present foundations. None of them were built of such material as to last for ages, because this would be too costly, and we are not convinced that the present location of the main buildings will be the most desirable in the years to come . . . As the buildings weaken and become too old for use, new ones will be built or they will be remedied or altered, and perhaps, as I have said, moved to other locations."



(left) Original AMORC Administration Building, built in 1928. (right) Today's AMORC Administration Building.



From 1927 to 1990 Rosicrucian Park served as the world headquarters of the Rosicrucian Order, AMORC. In order to meet the needs of the rapidly expanding membership around the world, many of the buildings were put up quickly and as inexpensively as possible. At one point, 350 employees at Rosicrucian Park served over 250,000 members worldwide.

Times have changed. There is no longer a single world headquarters for the Rosicrucian Order. Grand Lodges have been established around the world and their headquarters are in their home areas, rather than in one central location. Rosicrucian Park now has 36 employees who serve 8,500 members of the English Grand Lodge for the Americas.

San Jose is a different city from the sleepy little orchard town it was when Dr. Lewis settled here in 1927. Today, San Jose is the eleventh largest city in the United States and consistently ranks among the top three or four cities in the U. S. for highest cost of living.

With significantly fewer employees, the English Grand Lodge has no need for the surplus office space at Rosicrucian Park and some of the buildings need major repairs due to their age and years of limited maintenance.

Even if we wanted to reopen some of these buildings, to rent to an outside organization for example, we would have to renovate them, and any renovations would trigger the requirements to bring the buildings up to current code. For buildings built in the 1920s and 1930s, this would necessitate replacing antiquated wiring, plumbing, insulation, etc., as well as making them compliant with current ADA (Americans with Disabilities Act) requirements. These buildings would require an initial investment of one million dollars or more just to reopen them, and again we have no use for this extra space and would have no practical way to gain a return on that investment.



*Original Rosicrucian Egyptian & Oriental Museum, 1930's.*



*Today's Rosicrucian Egyptian Museum, built in 1966.*

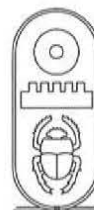



In addition to extensive repair and renovation work needed to properly maintain many functioning buildings, including the Grand Temple, Library, Planetarium, Administration, and Francis Bacon Auditorium buildings, widespread conservation work is needed to protect the artifacts in the Rosicrucian Egyptian Museum. When the cases were built, a glue was used which emits a gas that is harmful to the artifacts. Also, the fluorescent lights in the cases are damaging to the ancient objects. The artifact labels, the originals from 1966, are not current with modern knowledge of ancient Egypt and the museum also lacks sufficient fire detection and alarm equipment.

This is the current state of Rosicrucian Park.

However, the Park has had many different incarnations. We are now preparing for the future life of Rosicrucian Park. Some of the work is already in progress.

Regarding the Rosicrucian Egyptian Museum, extensive work to protect the artifacts has already begun. We have installed a new strobe fire alarm system with state-of-the-art fire detection and reporting. The Mummy Gallery (Gallery A) has already been completely renovated. The cases have been specially sealed to prevent harmful gases from leaking into the cases, thereby protecting the artifacts. The gallery has been painted and updated with a much more engaging presentation. The artifact labels have been updated to include the very latest research on ancient Egypt. As a matter of fact, the Rosicrucian Egyptian Museum is once again participating in some of this research. Fiber optic lighting will be installed in all the artifact cases in the Museum, and all galleries will be updated.

The Rosicrucian Peace Garden is going to be created in Rosicrucian Park. This garden, authentic to the 18th Dynasty, the period in which our venerated Pharaoh Akhnaton lived, will feature an outdoor temple, grape arbor, viewing dais, an array of historic plants, and a



*The original Amenhotep Shrine (left) and the present Akhnaton Shrine.*



*Plaza Fountain and gardens.*

reflecting pond to mirror this very special setting. The Rosicrucian Peace Garden will serve as a sanctuary of peace and an educational garden for the hundreds of thousands of guests who visit Rosicrucian Park each year. This is especially auspicious in light of the times in which we live and the upcoming AMORC World Peace Conference in San Jose in 2004.

The central fountain area of the Park will be completely renovated and expanded into a large outdoor plaza—the Ralph Lewis Memorial Plaza. The Rosicrucian Planetarium, the fifth planetarium built in the United States, will be re-roofed; repaired and painted, both inside and out; and will once again present science shows, including presentations on “The Ancient Skies” and “Ancient Mysteries.” The electrical wiring of the Grand Temple will be updated to current code, and general cosmetic upgrades will be completed.

The Rosicrucian Research Library will move into the Administration Building following renovations which provide environmental control for the rare manuscripts and books, as well as allowing easier access and more flexible hours for visitors. A laboratory, classrooms, study rooms, and conference rooms will also be added.

The Grand Heptad Temple for the Traditional Martinist Order will be created at Rosicrucian Park. Since the time of Emperor H. Spencer Lewis, the Traditional Martinist Order has become a more and more integrated part of Rosicrucian membership. This beautiful new temple, the Grand Heptad Temple, represents the strength of the Martinist tradition.

To allow Rosicrucian Park to function more harmoniously with the Earth's environment, we will convert Rosicrucian Park's primary energy source to solar power. San Jose is blessed with a sunny climate that can help to efficiently and safely meet the Park's needs for energy. Solar and other alternative energy sources will also significantly



*The Rosicrucian Planetarium, constructed in 1936.*



*Workman refurbishes sphinx with the Planetarium in background.*



*Rosicrucian Research Library and the dawn redwood.*

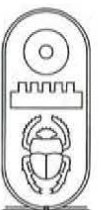



reduce our power costs. This energy conversion will be in keeping with the Order's history of being at the forefront of promoting scientific advances for the benefit of humanity. After all, Pharaoh Akhnaton, one of our first Rosicrucian Grand Masters, recognized the Aton, the solar disk, as the source of all life and energy on Earth. It will also reflect the Order's values regarding preserving the Earth's environment as stated in the most recent Rosicrucian manifesto, *Positio Fraternitatis Rosae Crucis*.

On the following pages are more details of the renovation of Rosicrucian Park. The estimated cost of this project is \$5 million. We have already received over \$1.5 million in gifts. Included is a chart showing the number of gifts in various categories that we need in order to meet our goal.

The members of the Rosicrucian Order, AMORC, and especially members of this Grand Lodge, have always been extraordinarily generous to the Order, and this is deeply appreciated. We, the caretakers of the Rosicrucian tradition, have this unique opportunity to further participate in creating The Future of Rosicrucian Park.

Sincerely and fraternally,

*Julie Scott*

Julie Scott  
Grand Master



Museum Curator Lisa Schwappach positioning a mummy case in Museum Gallery A.

Museum Curator Lisa Schwappach (center) with National Geographic's "Mummy Roadshow" co-hosts, Dr. Gerald Conlogue (right) and Dr. Ronald Beckett, Co-directors of Bioanthropology at Quinnipiac University, Hamden, Connecticut, during a videotaping of a mummy autopsy at the Rosicrucian Egyptian Museum.



©Engel Brothers Media, NYC. Courtesy of Engel Brothers Media. Photo: Larry Engel



# 75th ANNIVERSARY CAMPAIGN for ROSICRUCIAN PARK

New Rosicrucian Research Library and renovation of the Administration Building .....	\$1,000,000
Conversion to Solar Energy .....	\$1,000,000
Rosicrucian Peace Garden .....	\$900,000
Ralph Lewis Memorial Plaza .....	\$550,000
Renovation of the Rosicrucian Planetarium .....	\$450,000
Traditional Martinist Order Grand Heptad Temple .....	\$350,000
Renovation of Rosicrucian Egyptian Museum Galleries B, C, and D .....	\$250,000
Installation of Fiber Optic Lighting in the Rosicrucian Egyptian Museum artifact cases .....	\$250,000
Renovation of the Francis Bacon Auditorium .....	\$150,000
Renovation of the Grand Temple .....	\$100,000

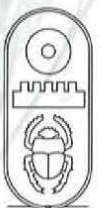
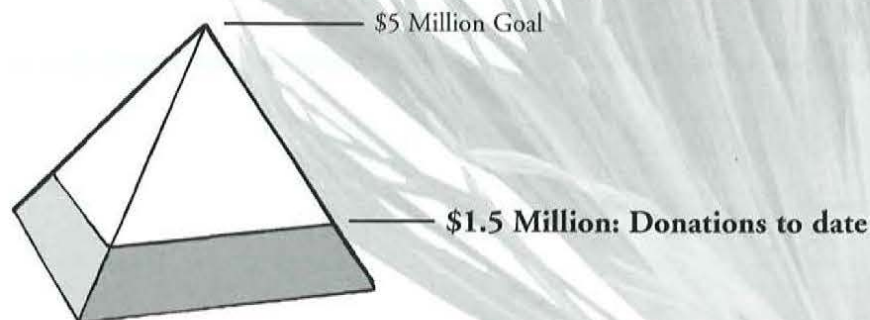

# 75th ANNIVERSARY CAMPAIGN for ROSICRUCIAN PARK GIFT TABLE

Gift Level	No. of Gifts	Value	Cumulative Value
<b>Akhnaton</b> \$1,000,000	1	\$1,000,000	\$1,000,000
<b>Nefertiti</b> \$500,000	1	\$500,000	\$1,500,000
<b>Hermes Trismegistus</b> \$250,000	2	\$500,000	\$2,000,000
<b>Thales</b> \$100,000	4	\$400,000	\$2,400,000
<b>Pythagoras</b> \$50,000	8	\$400,000	\$2,800,000
<b>Diotima of Mantinea</b> \$25,000	20	\$500,000	\$3,300,000
<b>Socrates</b> \$10,000	40	\$400,000	\$3,700,000
<b>Plato</b> \$5,000	80	\$400,000	\$4,100,000
<b>Francis Bacon</b> \$2,500	120	\$300,000	\$4,400,000
<b>Robert Fludd</b> \$1,000	300	\$300,000	\$4,700,000
<b>Isaac Newton</b> under \$1,000	500	\$300,000	\$5,000,000



(above) Rosicrucian Egyptian Museum frieze.





seum frieze.

pleted in the  
Garden soon  
Gallery D.  
the Sekhmet

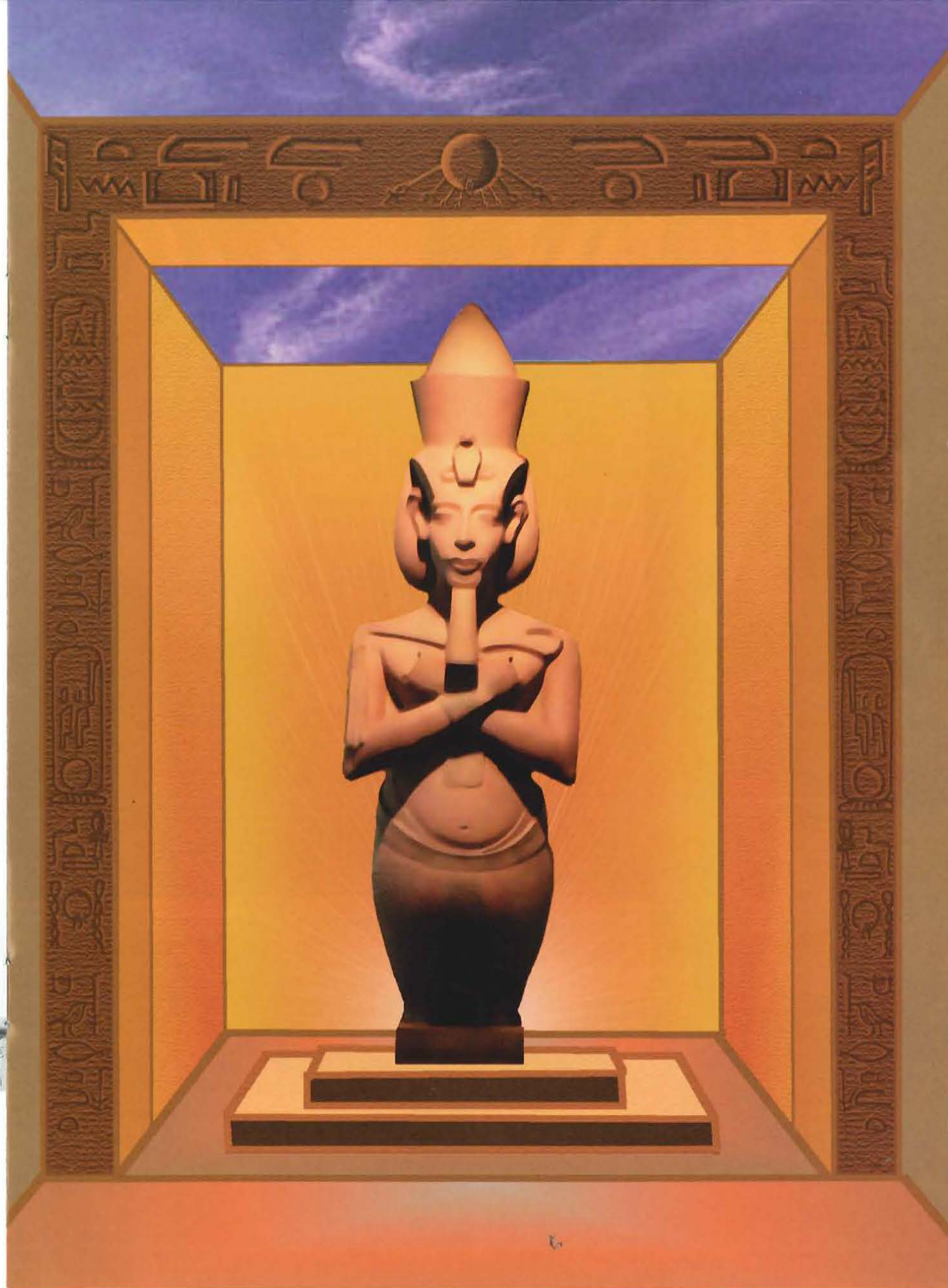







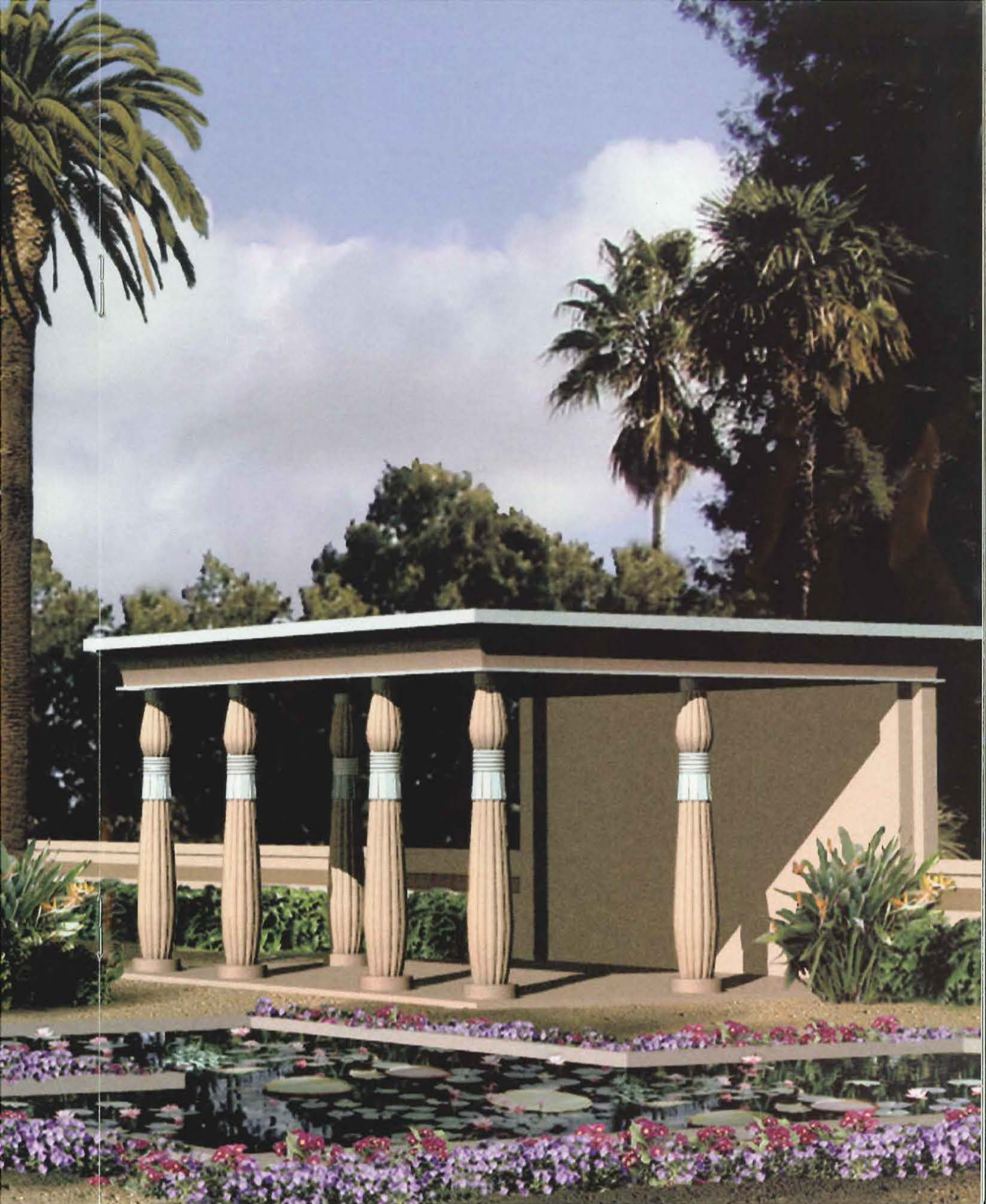



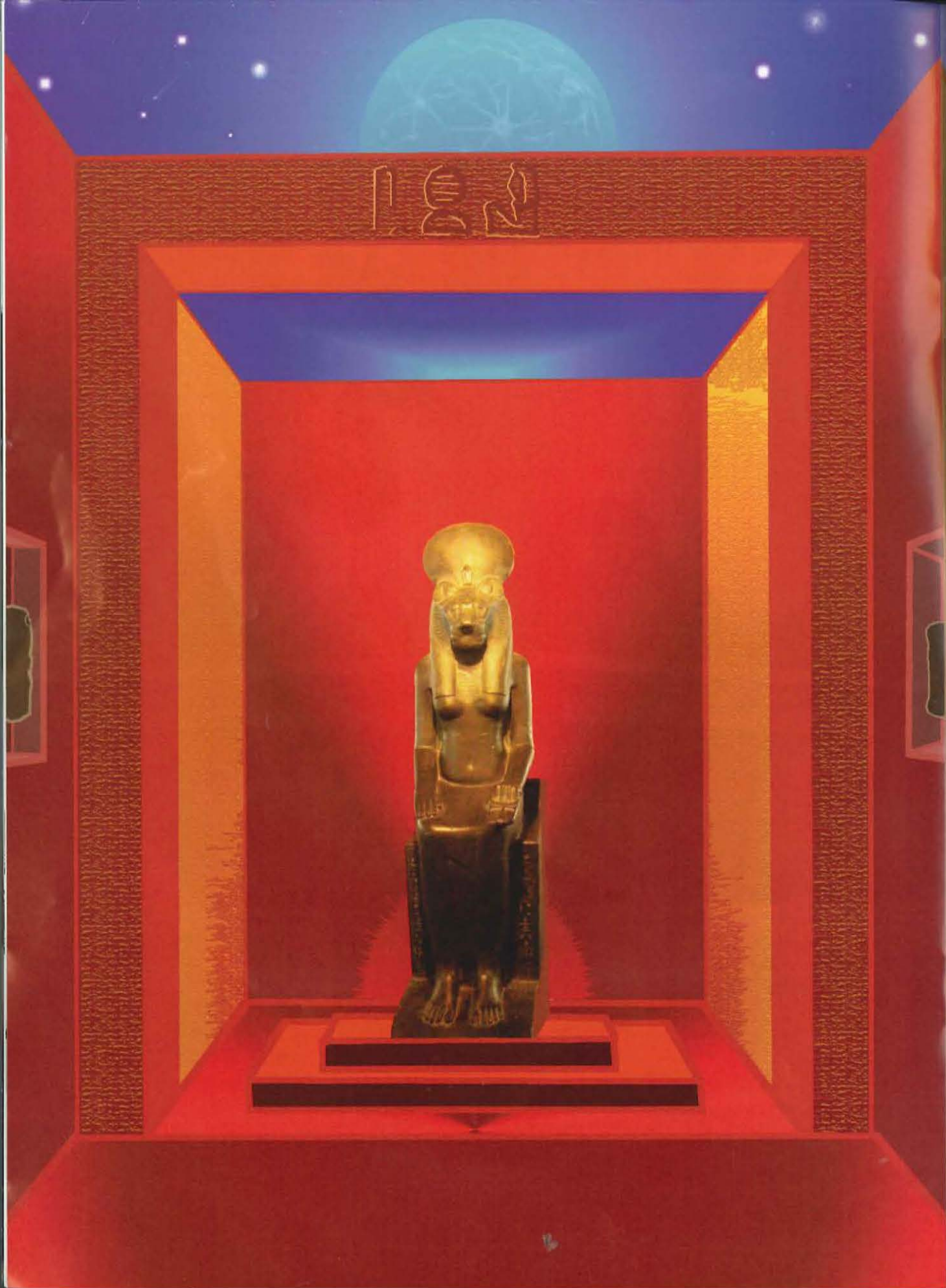



# Planting the Seeds for Our Order's Future

**T**he decisions you make today can sow the seeds for future growth of the Order and the continuation of its spiritual and humanitarian goals. By knowing what, when, and how to give, you can increase the impact of your gifts and in some cases, realize significant financial rewards and tax benefits. This is called planned giving.

What is involved in planned giving? In making a planned gift, financial, estate, and tax plans are taken into consideration. Depending upon your personal circumstances, there are a variety of ways in which you may be able to give.

Some of you have already taken steps to make a planned gift to the Order by remembering the Order in your will. If you have not done so, and you already have a will, it is a relatively simple matter to amend the will to include a bequest to the Order. If you have not yet made a will, you will find that planning a will can be a practical and fulfilling experience. By making a will, you mandate who will receive your property and who will handle your estate. You can make provisions for the care of children and loved ones. With a well-made will, you can minimize the impact of taxes and other costs to your beneficiaries. Most of all, your will can be a reflection of your values—a way of caring for loved ones and supporting charitable organizations, like AMORC, whose work is deeply significant to you.

For some members, a living trust may be preferable to a will. Living trusts, if revocable, may be changed at any time. Through a living trust, not only do you provide for distribution of your assets, but you can also plan for someone to handle your affairs if you become incapacitated, temporarily or permanently. Further, because living trusts are not subject to probate, details concerning your estate remain confidential, your assets are distributed expediently, and your beneficiaries may realize significant savings.

Another simple way to make a planned gift is to name the Order as a beneficiary of an insurance policy. This can be a way of making a significant gift to the Order in a very affordable way. Your insurance company can provide you with the appropriate forms. Also, if you have a paid up life insurance policy that is no longer needed, you might consider donating this policy to the Order. Not only would you be entitled to an income tax deduction for the cash surrender value, but the premiums you continue paying on the policy are also tax deductible. Upon your transition, the Order would receive the full value of the policy.

Charitable remainder trusts are a gift-planning vehicle that provides income for yourself and/or others you specify in the trust agreement. Upon transition of the beneficiary(ies), the remainder in the trust would go to the Order. If you set up an annuity-type trust, the annual payment would be a fixed dollar amount of at least 5 percent of the initial net fair market value at the creation of the trust. A unitrust agreement provides at least 5 percent of the net fair market value, determined annually. There are numerous tax advantages to either type of charitable remainder trust.

You might be asking yourself, "But what can I do to help the Order now?" Not all planned gifts have deferred benefits.

For example, stocks that have appreciated in value over a period of years may be donated by transferring the stocks. Capital gains tax would be avoided and a deduction could be taken on income tax. On the other hand, stocks that have depreciated in value may be sold, the proceeds donated, the capital loss taken on the federal tax return, and the proceeds deducted as well.

For members whose estates are large enough to place them in higher tax brackets, a charitable lead trust could be established and a designated percentage of the trust

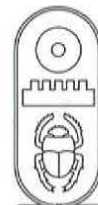



could be donated to the Order via payments made annually or more frequently. Upon the termination of the trust, the principal could either revert to family members, or to the Order or other charitable organizations. There may be gift and estate tax savings to the donor, and the annual payments may be deductible.

Real estate and other personal property may be donated to the Order during your lifetime. The fair market value may be deducted for tax purposes, and in the case of real estate, you would no longer have to pay property taxes. If you wish to donate real estate or other property, it is best to obtain written appraisals to determine market value. Also, you will want to obtain good counsel to determine whether it is best to donate the property or sell the property and donate the proceeds.

The role of professional advisors in planned giving is vital to both the donor and the recipient. Financial planners, estate planners, certified public accountants, or attorneys can help you come up with a giving plan that works for you. Professional advisors may also

coordinate plans with representatives of the charitable institutions who are the intended recipients of planned gifts. Remember, it is not only what you give, but when and how you give, that determines the most benefit your gifts may bring to you, your loved ones, and the Order.

If you would like more information about ways you can make a planned gift to the Order, please send an e-mail to:

*plannedgiving@rosicrucian.org*

or contact Soror Lisa Bigley.

---

*\*Please understand that the English Grand Lodge, AMORC, its officers, directors, and employees, are not in any way offering legal or tax advice. This article provides information of a general nature only. For specific situations, the appropriate professional advisor(s) should be consulted. Please keep in mind that laws vary from state to state, and that revisions in federal and state tax laws may occur. When considering planned gifts, an attorney's advice should be procured.*

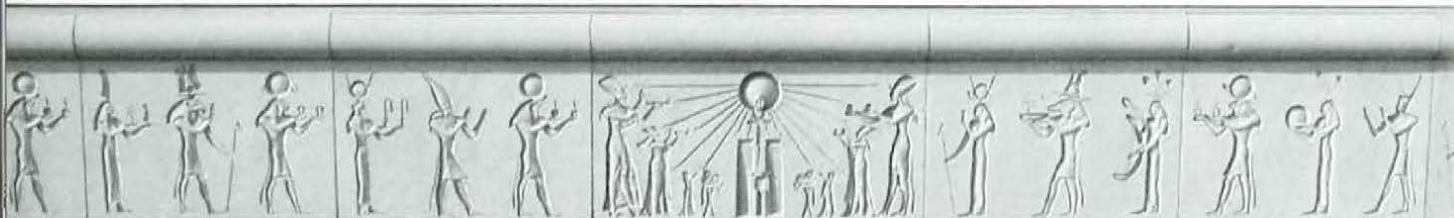

*Rosicrucian Egyptian Museum frieze*

## ROSICRUCIAN DIGEST

Official Magazine of the Worldwide Rosicrucian Order

*Editor:* Robin M. Thompson

*Assistant Editor:* Richard W. Majka

*Design & Layout:* C.H. Kawashima

Established in 1915 by the Supreme Grand Lodge of the English Language Jurisdiction, AMORC, Rosicrucian Park, San Jose, CA 95191. Statements made in this publication are not the official expression of the organization or its officers unless declared to be official communications.

**ROSICRUCIAN DIGEST** (ISSN #0035-8339) is published quarterly for \$12.00 per year, single copies \$4.00 (payment must be in U.S. dollars), by the Grand Lodge of the English Language Jurisdiction, AMORC, Inc., at 1342 Naglee Ave., San Jose, CA 95191. Periodicals Postage Rates paid at San Jose, CA, and at additional mailing offices. **POSTMASTER:** Send address changes to *Rosicrucian Digest* at 1342 Naglee Ave., San Jose, CA 95191-0001. Copyright 2002 by the Supreme Grand Lodge of AMORC, Inc. All rights reserved. Republication of any portion of *Rosicrucian Digest* is prohibited without prior written permission of the publisher.

Rosicrucian  
Digest  
No. 3  
2002



# From A Seed Springs A Mighty Tree

## An Idea Created Rosicrucian Park

by Robin M. Thompson, F.R.C.

*"Each day we intentionally, or indifferently, sow a seed. These seeds are our daily thoughts and actions. Nature nurtures them alike. Time will reveal their harvest. Will it be what we have sought from life?"*

—Ralph M. Lewis, F.R.C.

**E**nsconced between the Grand Temple and the Rosicrucian Research Library in Rosicrucian Park there grows a very special tree. This tall, slender, beautiful tree—a *Metasequoia*, or dawn redwood—has grown to its great height from a tiny seed planted many years ago by Mrs. H. Spencer Lewis in memory of her husband, the former Imperator of the Rosicrucian Order, AMORC.

Throughout the years and the changing seasons this tree continues to delight visitors to Rosicrucian Park: in spring with its fresh green, in summer with its solid-green conical profile, in autumn as its foliage turns a brilliant yellow. And as fall drifts into our rainy winter, and the temperature occasionally drops below freezing at night, this unusual conifer loses its leaves and the intricate delicate curves of bare twigs and branches—the “bones” of the tree—are revealed.

Surprisingly, this tree, whose bare limbs must reclothe themselves in

green each year, bears needles rather than true leaves and its small “cones,” resembling an evergreen conifer, are not, botanically speaking, true cones, but something similar—a precursor to the cone on the botanical development time scale. But, then, this tree’s place on that long time scale into the distant past is very early indeed.

Long, long ago, there were forests of *Sequoia* (redwoods) throughout the world—a foggy, misty Mesozoic world of swamps and thick forests. Most of those trees in that ancient forest no longer exist, or have changed, but the sequoias found a survival zone in California. A cousin of theirs, the metasequoia, had much the same habitat. It was recorded in fossils from many areas





of the world, including North America, as were the direct ancestors of the California sequoias. The metasequoia was considered extinct ages ago until 1941, when refugees pushing into the high mountains of war-torn China discovered an unusual, very tall and impressive tree growing in a hidden valley. There, in the high hilly country of south-central China's Hubei Province, the metasequoia, considered extinct for millions of years, was discovered growing and thriving. Just 1200 of these trees occupied that high, isolated valley. A living fossil!

Botanists called it the dawn redwood, for it truly came from the misty dawn of time. Its scientific name, now that it has been carefully studied and catalogued, is *Metasequoia glyptostroboides*.

Dr. Ralph Chaney, an eminent California botanist, determined to examine this remnant of forgotten ages as soon as civilian travel to China became possible again after World War II. And it was from among Professor Chaney's seedlings, after his return to Berkeley, California, that our tree was selected.

Once planted in Rosicrucian Park, the dawn redwood spread its roots and fairly leapt into the air. In 1952 it was belt-buckle height; the next year the same human measuring stick could barely reach the top of the young tree!

The dawn redwood must have liked its return to North America after an absence of eight million years for it was soon producing cones and seeds. Today, it has long since overtopped the adjacent Rosicrucian Research Library and now reaches higher than the nearby Grand Temple and other buildings in Rosicrucian Park.

To me, this story has meaning beyond that of how the seed of an ancient species of tree was planted and grew into the great tree that it is today—amazing as that story is. For there are so many parallels between how this ancient tree found a new home in a new land and how our ancient and timeless Rosicrucian teachings found a wonderful home in Rosicrucian Park.

The seedling of an ancient tree, long thought extinct, was brought to Rosicrucian

Park. It was planted. And although the ancestors of this ancient tree had lived here millions of years ago, who was to know whether this tiny seedling would grow and how it would make its way and thrive in this new land. However, the little seedling was lovingly nurtured and cared for as it grew into the wonderful tree we see today.

In the early twentieth century an ancient and timeless philosophy—the Rosicrucian teachings—were brought to the Americas from a faraway land by Dr. H. Spencer Lewis, who had received his initiation and instructions from the old Rose-Croix of France. The Rosicrucian Order had existed here long ago, and was even instrumental in our nation's founding, but its teachings had been long forgotten. Who but Dr. Lewis knew whether the Rosicrucian Order would find acceptance or thrive in this new setting. But thrive it did, and in 1927 Rosicrucian Park was founded as the Rosicrucian Order's new home. Here, the Order was lovingly nurtured and cared for by its officers, staff, and thousands of its students.

From Rosicrucian Park the Order grew and expanded into the expansive worldwide organization that it is today. The new system of dispensing and administering the Rosicrucian teachings, devised by Dr. Lewis, originated here in Rosicrucian Park, and from here this new way of doing things was exported to all areas of Rosicrucian activity throughout the world. And as the Light of Rosicrucianism was nearly extinguished amidst the darkness of war and strife in other lands, the Light, Life, and Love of Rosicrucian Park burned ever brighter "Through the night with the Light from above." Today, there are other Rosicrucian headquarters, and even other Rosicrucian Parks, but this is the *original* Rosicrucian Park.

Many years ago a tiny seedling was planted in a new home where it was lovingly nurtured and cared for as it grew into the wonderful tree it is today. In 1927 the Rosicrucian Order found a new home in a new land. That home is beautiful Rosicrucian Park. Just as with the tiny seedling, here the Order was given a fresh start, a new beginning, a more progressive way of dispensing its teachings, a new lease on life!



As the Order thrived and grew in its new home, generations of fratres and sorores loved and cared for, lived and breathed, and dreamed of Rosicrucian Park. Thousands considered the Park to be their spiritual home away from home. Many came every summer to its conventions and classes. And on returning home, they told their friends and neighbors about the Rosicrucian Order and its magnificent Rosicrucian Park, and thus new initiates were brought across its portals. For them it was a privilege, a responsibility, an honor, and a pleasure to support the Order's home in Rosicrucian Park through good times and bad, for this is where it all began.

Now, on its 75th anniversary, Rosicrucian Park is in need of restoration, renovation, some tender loving care, as the Rosicrucian Order is poised for new growth and expansion.

Fratres and Sorores, friends and colleagues, today we are the caretakers of Rosicrucian Park. Now is the time for us—for our generation—to express our love for the Rosicrucian Order and Rosicrucian Park. It is our privilege, our responsibility, indeed it is our pleasure, to care for this beautiful and unusual mystical place—our spiritual home away from home.

Right now, each and every one of us has the rare opportunity to be part of building something wonderful and vital for the future. It is up to us to leave something of great value to future generations. Let us express our gratitude for the benefits we have received from being part of today's great worldwide Rosicrucian movement that originated here in Rosicrucian Park. For after all,  
*it is our legacy!*

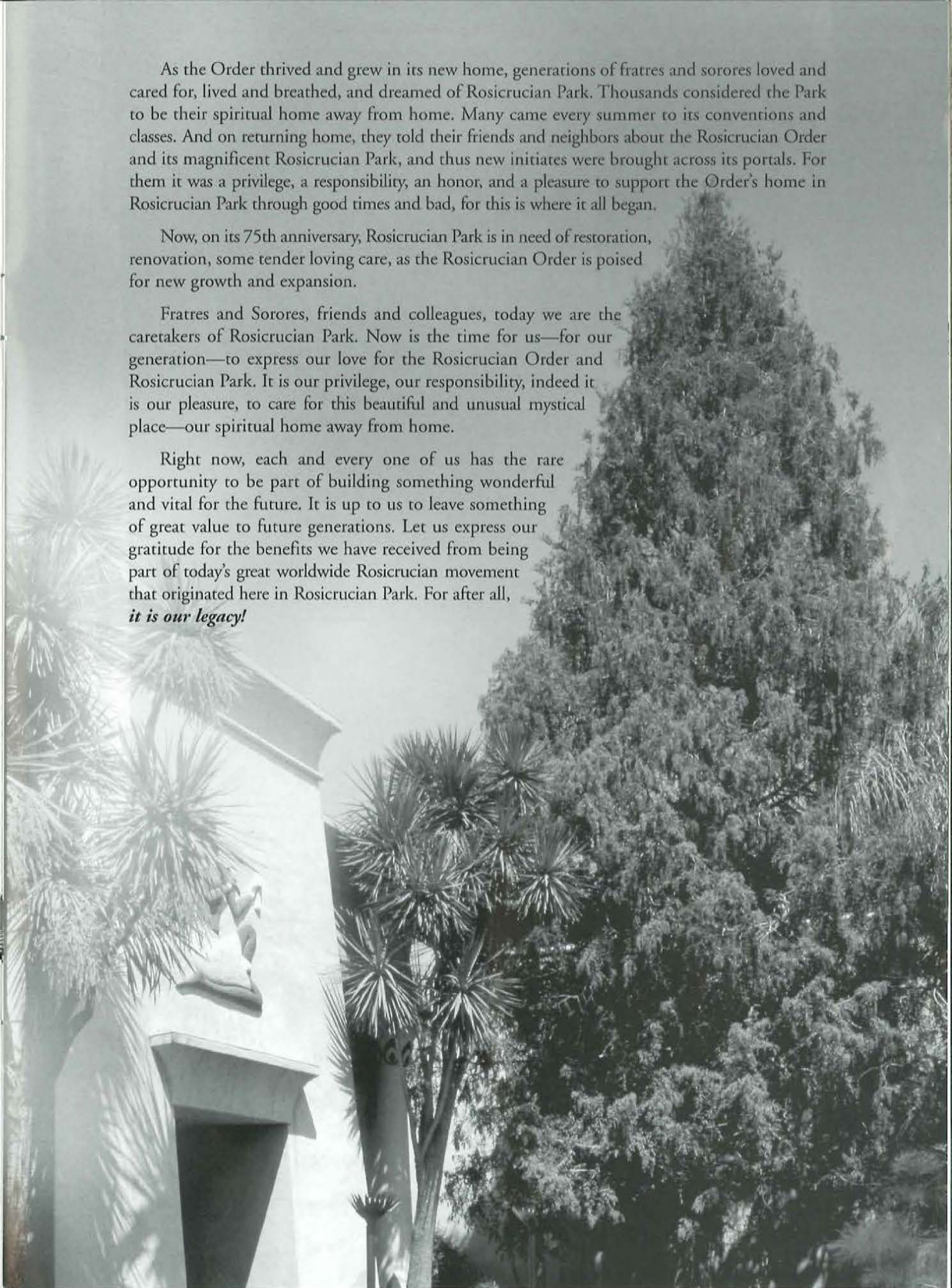









(Opposite page)  
Akhnaton Shrine

Beginning at the top left and moving clockwise, we see a view of Rosicrucian Park's gardens and Plaza Fountain, Francis Bacon Auditorium, Administration Building entrance, Rosicrucian Planetarium, Park Portal and Egyptian Obelisk, entrance to Rosicrucian Egyptian Museum's Rock Tomb in Gallery A, Horus statues, papyrus-lined walkway to the Rosicrucian Research Library, and directly above, interior of the Akhnaton Shrine.

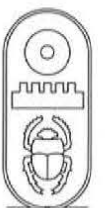

# Registration Form

## 2004 AMORC World Peace Conference

San Jose CA USA

June 29 through July 4, 2004

To register for the 2004 AMORC World Peace Conference: You may either register on online at: <https://www.regonline.com/?6526> or mail this completed registration form with your payment to:

**2004 AMORC World Peace Conference**  
**Rosicrucian Park, 1342 Naglee Ave, San Jose CA 95191**

-----  
 Please print clearly and use one form per participant:

☐ Frater      ☐ Soror      ☐ Colombe      Key Number \_\_\_\_\_

☐ Grand Councilor      ☐ Regional Monitor      ☐ Master

First Name: \_\_\_\_\_ Family Name: \_\_\_\_\_

Street Address: \_\_\_\_\_ City: \_\_\_\_\_

State/Province: \_\_\_\_\_ Zip /Postal Code \_\_\_\_\_ Country: \_\_\_\_\_

Email: \_\_\_\_\_ Telephone: \_\_\_\_\_

Language (please identify all languages spoken): \_\_\_\_\_

If possible, I prefer translation into:

☐ English      ☐ French      ☐ German      ☐ Portuguese      ☐ Spanish

Event	Fee	Total
First Temple Degree Initiation June 27 & 28 at the Grand Temple, Rosicrucian Park	AMRA	
RCUI Class: <i>"Mysticism Brought to Life: Putting the Rosicrucian Principles into Action"</i> June 29, 9 am-5 pm, Fairmont Hotel	\$75	
RCUI Class: <i>"The Rosicrucian Medicine Wheel"</i> June 30, 9 am-5 pm, Fairmont Hotel	\$75	
RCUI Class: <i>"Introductory Qabalah for Rosicrucian Students"</i> July 1, 9 am-5 pm, Fairmont Hotel	\$75	
Conference, July 2-4, Fairmont Hotel	\$150	
AMRA Donation		
Total amount enclosed:		

**Registrations will not be accepted after January 1, 2004. ABSOLUTELY NO registrations will be taken at the door.**

### PAYMENT BY CREDIT CARD ONLY

Card Number: \_\_\_\_\_ Exp. Date: Mo \_\_\_\_\_ Yr \_\_\_\_\_

Name on Credit Card (Please print clearly) \_\_\_\_\_

Signature: \_\_\_\_\_



# 2004 AMORC WORLD PEACE CONFERENCE

*Travel Back to the Source....*

San Jose CA USA  
June 29 through July 4, 2004

## Schedule Details

Monday, June 28, 1 pm to 9 pm: Check-in for those attending RCUI classes.

Tuesday, June 29, 9 am to 5 pm: RCUI class *"Mysticism Brought to Life: Putting the Rosicrucian Principles into Action"*—Edward Lee, FRC, Instructor

Wednesday, June 30, 9 am to 5 pm: RCUI class *"The Rosicrucian Medicine Wheel"*—Robin Thompson, FRC, Instructor

Thursday, July 1, 9 am to 5 pm: RCUI class *"Introductory Qabalah for Rosicrucian Students"*—June Schaa, SRC, Instructor

Thursday, July 1, 5 pm to 9 pm: Check-in for those attending the Conference only.

Friday, July 2 – Sunday, July 4: Conference program opens at 9 am on Friday morning and concludes at 6 pm on Sunday with a Chapter Convocation with our Imperator, Christian Bernard.

## Convocations at Rosicrucian Park

Convocations will be held on the evenings of June 29 – July 3 in the Grand Temple at Rosicrucian Park. Attendees will be assigned a date and time to attend one of the convocations presented. We will not be translating the discourses given in the Temple so attendees will be assigned to a convocation based on language. Space is extremely limited for these convocations and will be assigned based on early registrations. *Please book early if you are planning to attend one of the convocations in the Grand Temple.*

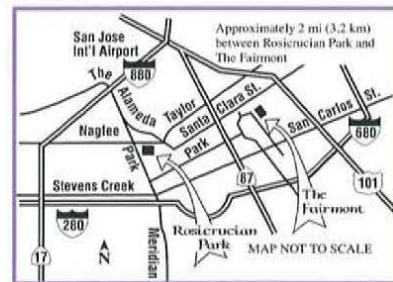

## Hotel Information

The Convention hotel is the elegant Fairmont San Jose Hotel, conveniently located in the heart of downtown San Jose approximately 2 miles (3.2 km) from Rosicrucian Park and only a few minutes from San Jose International Airport.

To book your room you may contact the Fairmont San Jose Hotel directly by phoning **1.800.346.5550** or **1.408.998.1900**, and specify that you are attending the Rosicrucian World Peace Conference. Our group booking code is **OAMO**. Online booking for our group will be available after February 28, 2003.





